

NOVATO FIRE PROTECTION DISTRICT FIRE LOSS MANAGEMENT DIVISION



Developed by *Forrest M. Craig*
Forrest M. Craig, Fire Marshal

Approved by *Jeffrey A. Mesner*
Jeffrey A. Mesner, Fire Chief

Fire Protection Standard 204

FIRE LANES

Date: 9/3/98

Revision: 1/8/01

Page: 1 of 5

This standard has been developed pursuant to Article 9, Uniform Fire Code as adopted by ordinance by the Novato Fire Protection District. It is intended that this standard be used as a guide for installation and placement of signs and markings designated as a Fire Lane, where required by the Fire Marshal, in order to provide adequate Fire District vehicle access.

I. General

- A. “No Parking Fire Lane” signs and curb markings shall conform to the requirements specified in Option #1 or Option #2 outlined below as required by the Fire Marshal.
- B. Signs and curb markings shall be installed on any highway, at any curb, or in any location in a publicly or privately owned or operated off-street parking facility, required to be posted by the Fire Marshal, in order to provide the necessary unobstructed width and adequate turning radius of Fire District apparatus.
- C. All signs and curb markings are to be installed and maintained by the property owner.
- D. All curbs adjoining Fire Lanes or posted areas shall be painted red and labeled “No Parking Fire Lane”. Curb markings and lettering shall conform to Figure IV.
- E. Detailed plans of the proposed Fire Lane markings shall be provided to the Fire Loss Management Division for review prior to installation.
- F. Signs and curb lettering are subject to the approval of the Fire Marshal.

II. Option #1 – No Parking Signs –Figure VI - Sign #1

- A. Location
 - 1. Signs marking Fire Lanes are to be spaced so they are within 3 feet of each end of curbed areas and spaced a minimum of fifty (50) feet apart thereafter (see Figures I and II.)
 - 2. In addition, 1 sign is required for each island adjacent to a Fire Lane or access road if the road width is less than 20 feet (see reference A, Figure II).
 - 3. Signs are to face oncoming vehicular traffic.
 - 4. All curbs adjoining Fire Lanes or posted areas shall be painted red and labeled (see Figure IV).



Developed by *Forrest M. Craig*
 Forrest M. Craig, Fire Marshal
 Approved by *Jeffrey A. Messted*
 Jeffrey A. Messted, Fire Chief

Fire Protection Standard 204

Date: 9/3/98

FIRE LANES

Revision: 1/8/01

Page: 2 of 5

Figure I

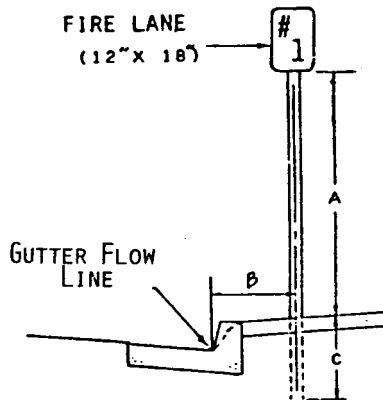

POST INSTALLATION

A = 7' in sidewalk or pedestrian areas

B = 18" with standard curb, 24" width rolled curb, to center of post.

C = 24" minimum embedment

Note: Signs may be mounted on existing posts or buildings, if post or building is no more than 24" from curb or edge of road surface.

Figure II

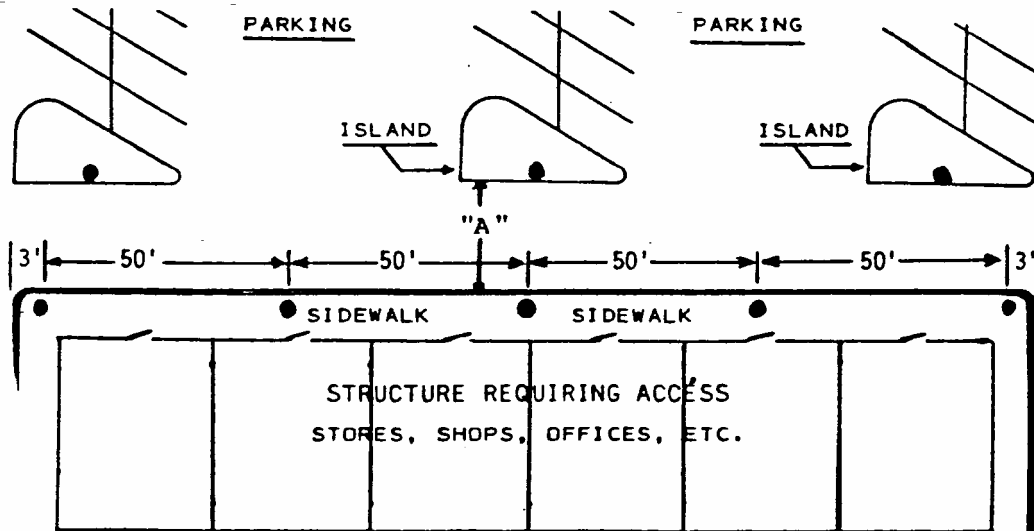



Developed by *Forrest M. Craig*
 Forrest M. Craig, Fire Marshal
 Approved by *Jeffrey A. Messted*
 Jeffrey A. Messted, Fire Chief

Fire Protection Standard 204

FIRE LANES

Date: 9/3/98

Revision: 1/8/01

Page: 3 of 5

III. Option #2 – Entrance Signs (see figure III, sign #2)

A. Sign #2 Locations

1. One (1) sign is required at all points of entry to properties with marked parking stalls. (see figures III and V).
2. Signs are to face oncoming vehicular traffic.
3. All curbs adjoining fire lanes or posted areas to be painted red and labeled (see figures IV and V).

Figure III

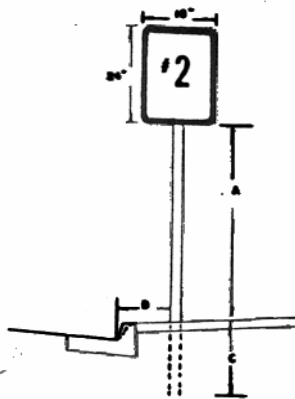

SIGN AND POST INSTALLATION

Sign #2

A = 7' in sidewalk or pedestrian areas

B = 18" Standard Curb
 24" Rolled Curb

C = 24" minimum embedment

Note: Signs may be mounted on entrance gates, building, or existing posts if the above are within 24" of the curb or edge of road surface.



Developed by *Forrest M. Craig*
 Forrest M. Craig, Fire Marshal
 Approved by *Jeffrey A. Mesner*
 Jeffrey A. Mesner, Fire Chief

Fire Protection Standard 204

Date: 9/3/98

FIRE LANES

Revision: 1/8/01

Page: 4 of 5

Figure IV

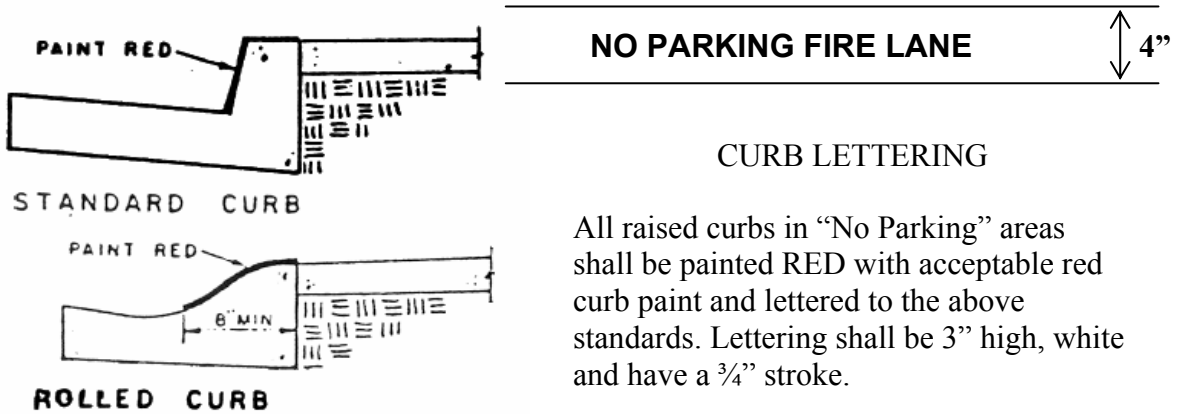
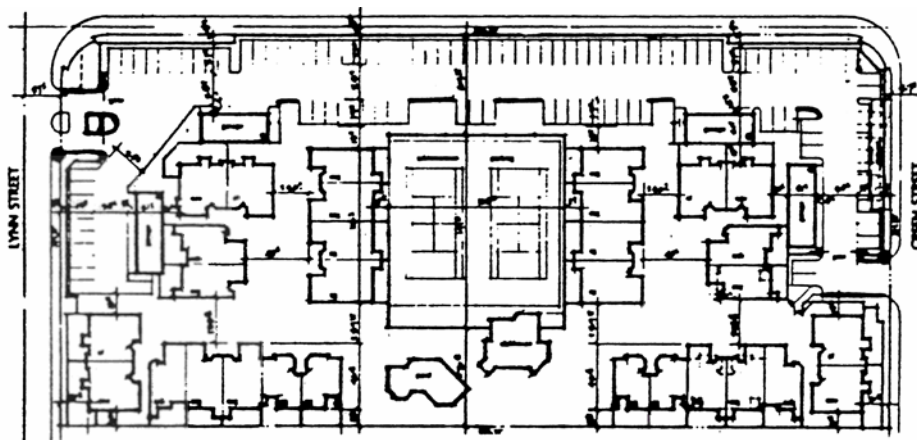

Figure V



● = POST WITH SIGN #2 — = RED CURBS

NOVATO FIRE PROTECTION DISTRICT FIRE LOSS MANAGEMENT DIVISION



Developed by Forrest M. Craig
Forrest M. Craig, Fire Marshal
Approved by Jeffrey A. Messted
Jeffrey A. Messted, Fire Chief

Fire Protection Standard 204

FIRE LANES

Date: 9/3/98

Revision: 1/8/01

Page: 5 of 5

Figure VI

Sign #1



Fire Lane Sign

12 X 18"
Red on White
Reflectorized
.063 Gauge

Sign #2



Entrance Sign

18" X 24"
Red on White
Reflectorized
.080 Gauge

Note: All information on signs must appear as shown.